

PART 1: CONNECTING IPAD & PRINTER

1. Open iPad, no passcode required
2. Ensure iPad is connected to WIFI (ie: Store WIFI, personal hotspot, or portable wifi)
3. Plug in printer to outlet
4. Once printer is on, click on the settings button to connect to WIFI



5. Click on the LAN settings



6. Click on WIFI



7. Click on WIFI setup



8. Click on Manual Connect



9. Choose your WIFI network



Important: iPad and Printer must be on the same WIFI network

PART 2: ACCESSING LABEL SITE

1. To ensure you have the updated Label Site, open iPad Settings, Click Safari and click "Clear History and Website Data"
2. Click on Pernod Ricard App on iPad Homepage to enter the label site

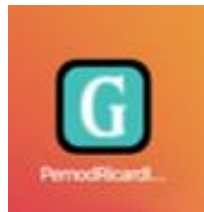
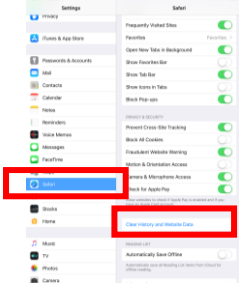

3. On the Homepage choose one of the label programs (Always On or Holiday specific)

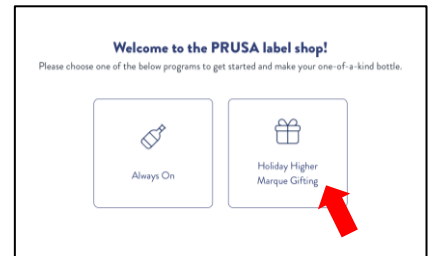

4. Choose which brand/SKU you would like to customize



5. Choose your font and choose a suggested message in the drop down or add in your completely custom message (character limit applies)

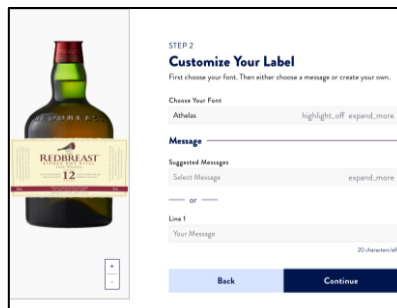

6. Add in your contact info and select the "Print Your Label" button to move forward with printing. You will then receive the confirmation Thank You Page

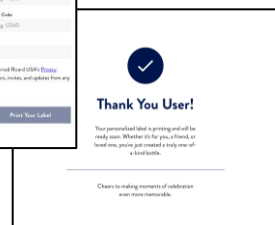
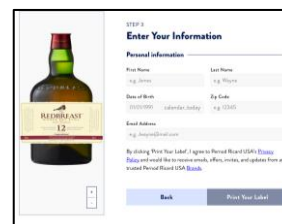

PART 3: PRINTING & APPLYING

1. The customized message will pop up in your browser – the page is synced with each brand label and will print in the correct spot

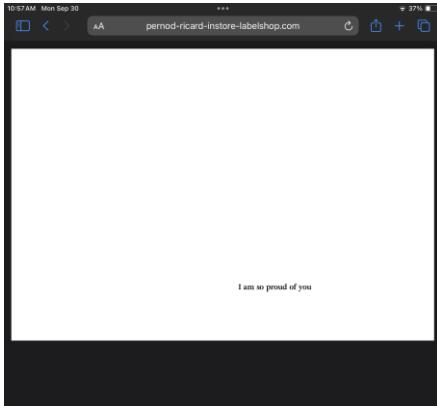

2. Load the label face side up, on the right side of the printer drawer (exactly as pictured below). Ensure the alignment bar slides to the left of the label



3. On the iPad, click on export button and select "Print"

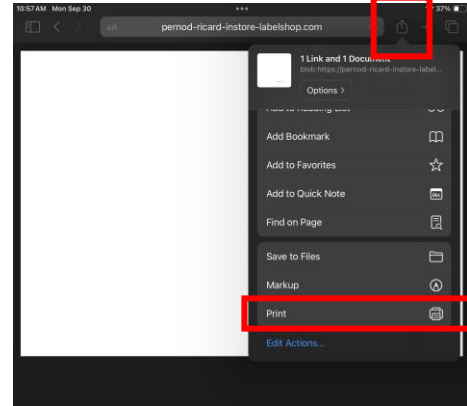

4. Make sure printer is connected, click print in color and then click "Print" in top right corner

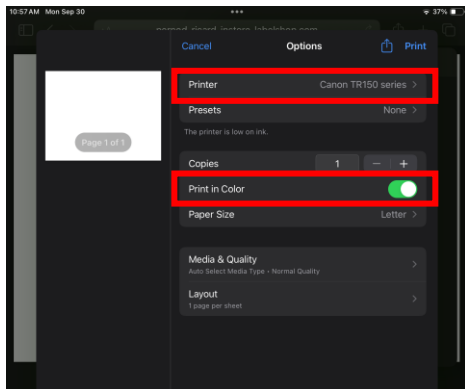

5. Your customized message will print on the label



6. Gently peel the label starting at the top left corner



7. Apply the label to the bottle, starting at the top left corner, slowly lower the label to ensure no bubbles



8. Gift your personalized bottle to a friend or loved one and enjoy!



Tip: if you encounter text alignment issues, go to printer Settings → Maintenance → Print Head Alignment → Start Print Head Alignment, using a piece of paper

If you experience any issues or have questions, please contact the HALO Support Team at pernodstorelabels@halo.com